



D1® Spa Connect



Table of Contents

D1 Spa Connect	1
Compatibility requirements	1
Compatible devices	1
Installation	1
Models Not Equipped with the D1 Spa Connect Option	1
Installation Tips	1
General installation of D1 Spa Connect for the Bay Collection	1
General installation of D1 Spa Connect for the Reflection Collection	2
Set Up	2
Download Application	2
Connect your D1 spa.....	2
Connect your spa with your home Internet network.....	2
Start the D1 Spa Connect App.....	3
D1 Spa Connect Specifications	4

D1® Spa Connect

WARNING: Please read the D1 Spa Connect Instruction Manual prior to installing or connecting the unit.

Note: Installation of the D1 Spa Connect must be done by an authorized dealer, authorized service center or a qualified technician.

Compatibility requirements

D1 Spa Connect module works with 2015+ Bay and Reflection Series.
Model number C01782-60NTYU.

Compatible devices

- iPod touch (3rd generation and later)
- iPhone (3GS and later)
- iPad Requires iOS 5.0 and higher
- Android 2.2 and higher, compatible with Google Play

IMPORTANT INFORMATION

- The D1 Spa Connect is a 802.11b module
- The D1 Spa Connect is not compatible with the WEP security or WAP Enterprise, WPA2 Enterprise and WPA2/WPA Mixed Enterprise
- Routers blocking broadcast messages and/or using WEP encryption are not compatible with the D1 Spa Connect

For models equipped with the D1 Spa Connect go directly to the set up section.

Installation

Models Not Equipped with the D1 Spa Connect Option

WARNING: Turn OFF power to the spa!

Note: Installation of the D1 Spa Connect must be done by an authorized dealer, authorized service center or a qualified technician.

Installation Tips

- The unit must be installed as high as possible, under the skirt, at least 12" (30 cm) away from any metal component or structure. This is necessary to ensure proper signal transmission.
- The D1 Spa Connect module should be installed as close as possible to the house to optimize the signal strength. It is recommended to install the side of the spa with the D1 Spa Connect module facing the house, Figure 1. In some cases, it will be necessary to relocate the unit once the spa is installed in the yard. The best possible installation location must be used; in order to have the best connection between the home router and the D1 Spa Connect module.
- We recommend that you install the unit with #8 PAN head screws (screws are not included).
- Route the cable and leave some loose, so the D1 Spa Connect module can be moved in case of reception problems.

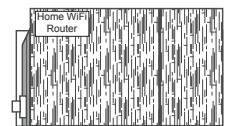
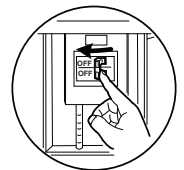

Figure 1

General installation of D1 Spa Connect for the Bay Collection

WARNING: Turn OFF power to the spa!

1. Locate the front panel.
2. Remove the two trim pieces and the center panel.
3. Install the D1 Spa Connect Module.
4. Remove the cover to the spa controller and locate the "CO" connection.
5. Connect the D1 Spa Connect Module cable to either of the two "CO" connections.
6. Reinstall the spa controller door, the front panel and trim pieces.
7. Turn the breaker back ON.

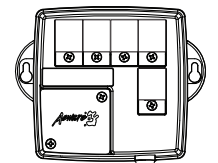
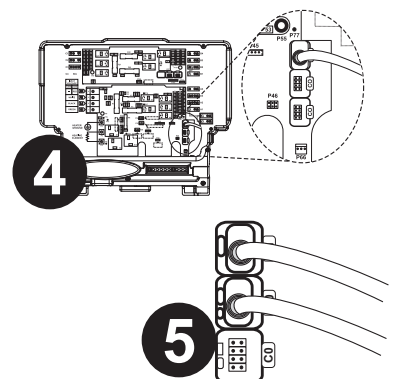
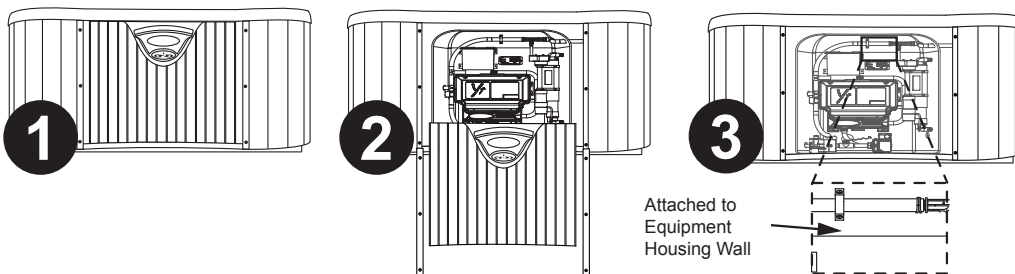

Figure 2



General installation of D1 Spa Connect for the Reflection Collection

WARNING: Turn OFF power to the spa!

1. Locate the front panel.
2. Remove the two trim pieces, the center panel and one of the front corner panels.
3. Install the D1 Spa Connect Module at one of the front corners. Some modifications might be necessary.
4. Remove the cover to the spa controller and locate the “CO” connection.
5. Connect the D1 Spa Connect Module cable to either of the two “CO” connections.
6. Reinstall the spa controller door, the corner panel, the front panel and trim pieces.
7. Turn the breaker back ON.

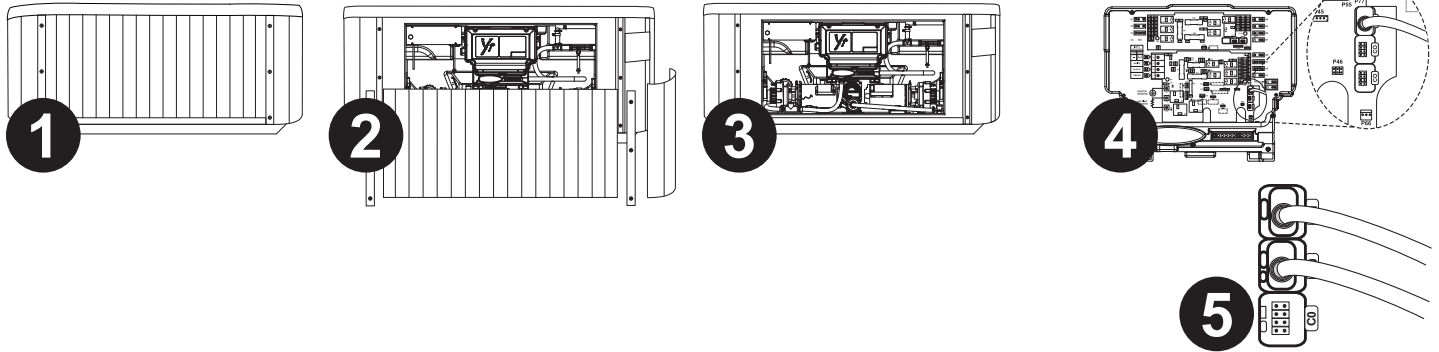
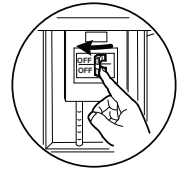

Set Up

Download Application

1. Go to the iTunes App Store for iOS device.
2. Both versions of the app are waiting for you at the App Store for iOS devices and the Google Play Store for Android devices - search for “D1 Spa Connect” then click on the version you want to install.



Connect your D1 spa

The D1 Spa Connect module includes a built-in Wi-Fi transceiver that allows you to communicate with your devices. D1 Spa Connect allows you to use the Internet to control your spa. The following steps will instruct you how to connect with your spa.

With the D1 Spa Connect Wi-Fi module, you can use the D1 Spa Connect app to control your hot tub even when you aren't within arm's reach. You'll need:

- A D1 Spa with a D1 Hub control panel
- A D1 Spa Connect module already installed in your spa
- A strong home Wi-Fi Internet connection
- A smartphone with the downloaded D1 Spa Connect app

Connect your spa with your home Internet network.

1. On your D1 Hub control panel, press the settings button.
2. Using the Up and Down buttons scroll down to Wi-Fi and push the button next to Wi-Fi, indicated by a small illuminated blue arrow, Figure 1.
3. Your spa will begin to search for your home Wi-Fi Network.
4. Use the up and down arrows to find your home Internet network from the list
5. Press the select button to choose the network.
6. Now enter your password using the top right button to toggle between uppercase, lowercase and numerals.
7. Use the up and down arrows on the right to scroll through the characters.
8. Use the light bulb button to select the character and advance to the next space until your complete Wi-Fi password has been entered. Once you've verified that your Wi-Fi password has been entered correctly, push the button to the left of your password to connect, indicated by a small illuminated blue arrow.
9. Now that your spa is connected to your home Wi-Fi network, you can download the D1 Spa Connect app to your smartphone.

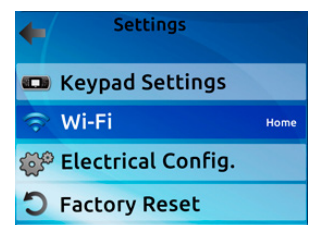

Figure 1



Figure 2

Start the D1 Spa Connect App

Note: In order to connect your app with your D1 Spa for the first time, you must use the same home Wi-Fi network that you used to connect your spa.

1. Once the app is installed, open the D1 Spa Connect app.
2. Tap OK to add your spa, Figure 3.
3. Tap OK again to confirm that your phone is on the same Wi-Fi network as your spa, Figure 4.
4. Once your app detects your spa, select your module's unique ID, Figure 5.
5. Give your spa a name and select OK, Figure 6-7.
6. Finally, you will be asked to enter your spa's serial number and your contact information and you'll be ready to control your Dimension One spa, even when you aren't within arm's reach, Figure 8.

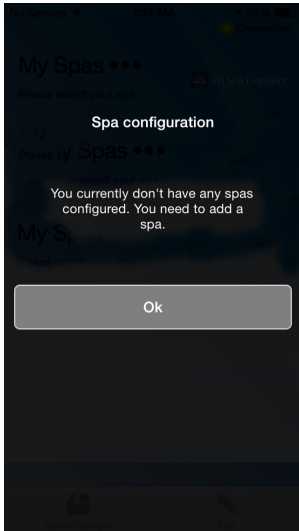

Figure 3

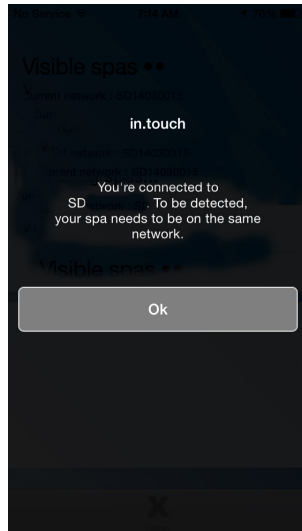

Figure 4

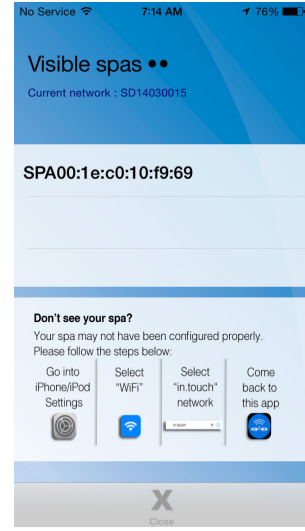

Figure 5

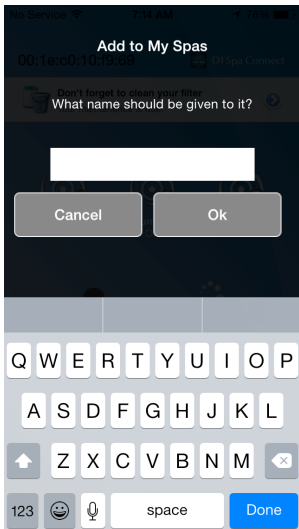

Figure 6

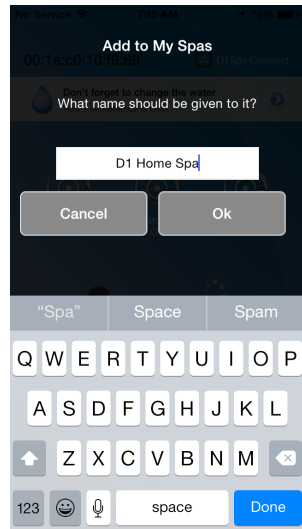

Figure 7

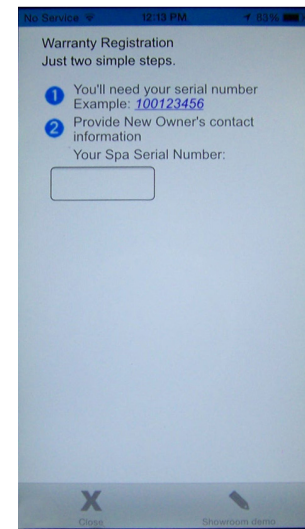

Figure 8

Note: Appearance could vary from the screens shown depending on the type of phone you are using.

For an operations video, go to <http://www.d1spas.com>.

D1 Spa Connect Specifications

Environmental ratings:

Humidity: Up to 85% non condensing

Operating temp.: -4°F (-20°C) to 140°F (60°C)

Storage temp.: -22°F (-30°C) to 185 °F (85°C)

Regulatory Compliance Information

United States

Contains FCC ID: W7OZG2100-ZG2101

This device complies with Part 15 of the FCC Rules. Operation is subject to the following two conditions:

- (1) this device may not cause harmful interference, and
- (2) this device must accept any interference received, including interference that may cause undesired operation.

This equipment has been tested and found to comply with the limits for a Class B digital device, pursuant to part 15 of the FCC Rules. These limits are designed to provide reasonable protection against harmful interference in a residential installation. This equipment generates, uses and can radiate radio frequency energy, and if not installed and used in accordance with the instructions, may cause harmful interference to radio communications. However, there is no guarantee that interference will not occur in a particular installation. If this equipment does cause harmful interference to radio or television reception, which can be determined by turning the equipment off and on, the user is encouraged to try to correct the interference by one or more of the following measures:

- Reorient or relocate the receiving antenna.
- Increase the separation between the equipment and receiver.
- Connect the equipment into an outlet on a circuit different from that to which the receiver is connected.
- Consult the dealer or an experienced radio/TV technician for help.

To satisfy FCC RF Exposure requirements for mobile and base station transmission devices, a separation distance of 20 cm or more should be maintained between the antenna of this device and persons during operation. To ensure compliance, operation at closer than this distance is not recommended. The antenna(s) used for this transmitter must not be co-located or operating in conjunction with any other antenna or transmitter.

Canada

Contains IC: 8248A-G21ZEROG

Europe

The MRF24WB0MA/MRF24WB0MB module has been certified for use in European countries. The following testing has been completed:

Test standard ETSI EN 300 328 V1.7.1 (2006-10):

- Maximum Transmit Power
- Maximum EIRP Spectral Density
- Frequency Range
- Radiated Emissions

Test standards ETSI EN 301 489-1:2008 and ETSI EN 301 489-17:2008:

- Radiated Emissions
- Electro-Static Discharge
- Radiated RF Susceptibility

The modules are fully compliant with

- Radiated Emissions EN 55022
- Electrostatic Discharge EN 61000-4-2
- Radiated Immunity EN 61000-4-3
- EN 60950-1
- CE-Mark
- RoHS

Specifications and design are subject to change without prior notice.



1819 Aston Avenue, Suite 105 • Carlsbad, CA 92008 • www.d1spas.com

DIMENSION ONE SPAS®

P/N 6530-396 B/02-16